



THE INTERNATIONAL STUDENT CITY OF COPENHAGEN

A PLACE FOR GLOBAL RELATIONS

This master plan for The International Student City of Copenhagen, ISCC, has been inspired by the spirit and the philosophy behind the Cité Internationale Universitaire de Paris, La Fondation Danoise, La Maison de Norvège, Maison Heinrich Heine and La Maison des Étudiants Suédois, all CIUP, Paris.

The master plan was created by Henning Larsen Architects and Jørgen Rossen on behalf of the founders of the idea for an international student city in Copenhagen.

We thank “The Circle of Friends” for their moral and financial support of the project.

Further we are deeply thankful for the support given us by Lord Mayor Frank Jensen of the City of Copenhagen, the management of By & Havn I/S, Jens Kramer Mikkelsen, Michael Soetmann and Britta Køster, University of Copenhagen, Copenhagen Business School CBS, IT University of Copenhagen, Aalborg University, DSF Danske Studerendes Fællesråd, NorskeGruppen ASA, the Ambassador of the Republic of Armenia, ANSA Association of Norwegian Students Abroad, DIDA Föreningen av Svenska Dottarbolag in Denmark, Hedorfs Fond, Aage V. Jensen Fonde, UngesBoligService.dk and Danske Bank Fonden.

Special thanks go to Rector, President of Copenhagen Business School, Per Holten-Andersen, who from the very beginning has seen the need for much more housing in Copenhagen for foreign and Danish students. Furthermore, Rector clearly saw the cultural and financial benefits that Copenhagen would reap from having an international student city of these dimensions.

The founders: Louis Becker, Christian Gjersøe, Per Stig Møller, Dr. Sam Nilsson, Anne Dorte Riggelsen, Morten Riise-Knudsen and Jørgen Rossen.

INDEX

Introduction	5
International Student City	6 - 9
Organisation	10
Vision	11
Location and Context	12 - 13
Concept Diagrams	14 - 15
Themes and Student Activity	16
Site Plan	17
Perspectives	18 - 19
Budget	20 - 21
Building Cluster Diagrams	22 - 23
Airflow Studies	24
Construction Phases	25
Building Clusters and Areas	26 - 27
Building Regulations	28 - 29
Acknowledgements and Contacts	30 - 31
Appendices	33 - 45

.....the vision of the International Student City of Copenhagen (ISCC) project is to create and build an international student city in Copenhagen as a Nordic equivalent to the Cité Internationale Universitaire de Paris (CIUP) initiated in the 1920s. With CIUP's almost uninterrupted success for a hundred years, it is the idea to create and build ISCC in Copenhagen based on the same principles and philosophy as has been the case in Paris....

The Original Founders of ISCC:

Jørgen Rossen, Rossen Denmark

Christian Gjersøe, Corpus Ejendomme

Louis Becker, Henning Larsen Architects

Anne Dorte Riggelsen, Ambassador

Per Stig Møller, MP

Dr. Sam Nilsson, Prof. Emeritus, Chalmers Göteborg

Morten Riise-Knudsen, Lawyer

INTRODUCTION



The purpose of the ISCC project is to alleviate the shortage of housing accommodations for foreign and Danish students in Copenhagen and to make the Ørestad region (Copenhagen, Malmö and Lund) more attractive for Nordic and foreign students as a Nordic university and research metropolis center.

In 2012, Denmark had about 18.000 foreign students, of which the majority were living in Copenhagen. Every year the Erasmus Organization Program exchanges 200.000 students with the universities in Europe with about 8.000 students today in Copenhagen. The Danish universities are popular, and have many subjects to offer in higher education such as natural sciences, nuclear physics, pharmacology, environmental research, medical and health, all aspects of welfare state, political science, marketing, design, economy and others. To reinforce and ensure that Copenhagen will remain popular for students globally, the ISCC will support the international policies of higher education and research institutions by accommodating their students and researchers.

The location of the ISCC will be at a 15 ha land area in Ørestad, next to Sundby Metro Station. The land is currently owned by By & Havn I/S (State of Denmark and the Municipality of Copenhagen) and agreed to be reserved for ISCC until December 31, 2014 through a "Letter of Intent" from By & Havn I/S. The location permits expansion over the next 25-50 years and is chosen because of its close proximity and easy access to all the universities via the Metro line (3 minute service) and via the Öresund train to Malmö and Lund. The international Kastrup airport is nearby.

The size of the ISCC project is planned to grow and offer about 5.000 studio apartments distributed over 40 different nation houses over a period of 10-15 years. The initial phase (3-4 years) is for 1.000 apartments with a separate International Culture House (5.000 m² floor area) for common activities such as meeting and lecture rooms, cafeteria, sports activities, music- and theater halls, library, smaller shops etc.

The financing of the ISCC project will follow the principles introduced by the Minister of Education in Paris in the 1920s, Mr. André Honnorat: The land should be donated by the Government and the Municipality to an independent foundation managed by the universities. Nations that have students in Copenhagen should be encouraged via sponsors, commercial organisations or foundations to finance the construction of their nation's student homes.

The ISCC, which is a private non-profit organisation, will offer student accommodation of high quality with a integrated vibrant urban setting at competitive market rates. An international student hub in the heart of Copenhagen.



THE INTERNATIONAL STUDENT CITY

A window to the world

ISCC project will figure as a cultural center in Copenhagen. Every nation's house in ISCC will have its own cultural calendar with concerts, theatre, art expositions and speeches. These events will be both of a specific national character and multinational. Thus little parts of the entire world enter Copenhagen. Students get together and create new, inventive culture together. The same goes for academic projects and philosophical debates.

Why bring students together ?

In a globalized world, the challenges of tomorrow must be met with international solutions and answers. ISCC will be an extraordinary example of how these solutions are formulated when students from all over the world live and study together. The interaction between students, when they live together, creates a capacity in which innovation, ideas and friendships emerge. This capacity contributes to the universities, the students, culture and society as a whole.

A window to the world

The principles, atmosphere and vision of Cité Internationale are not restricted to Paris only, but applicable and highly required in innovative and knowledge cities. Copenhagen is indeed such a city! Having an international student city with thousands of international and Danish students together will contribute tremendously to entrepreneurship, knowledge and research, culture and international orientation. As a student in Copenhagen, getting the opportunity to live and engage in an international community such as The International Student City of Copenhagen will be a great opportunity, and impact both the study period with friendship and cultural exchange, but also the students' future possibilities and network.

Copenhagen is growing and developing increasingly these years, and many new students arrive from within Denmark and internationally, thus the moment for establishing The International Student City of Copenhagen is optimal. In creating a vibrant, lively, international and innovative capital, The International Student City of Copenhagen will be essential. As a young Norwegian CBS student said: "Copenhagen has it all! – we just need good housing for the students".

Living together - The law of Brassage

We want to help build a peaceful world by creating a place for international interaction, where young people from throughout the world would learn to live together. The ISCC institution seeks to facilitate their stay and develop the experience of living together by creating a forum for interaction and high-level debates, promoting diversity and encouraging cultural and intellectual exchanges – the ISCC intends to pursue its stated mission in order to work towards the building of a better world.

"The law of Brassage" - mixing - will apply to every student home in ISCC, meaning that no more than 50% of one nationality will occupy one particular student home. This will prevent ghettoization.

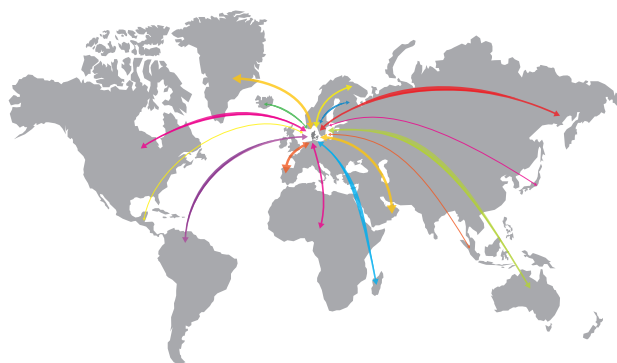

"With this growing amount of incoming students to Copenhagen throughout the years, the municipality of Copenhagen has a unique opportunity to position itself as the leading city of knowledge, study and research in the northern European area. This, by meeting the greatly increasing demand for student accommodation both from international and national students."



A visionary project through sponsorship

We hope this utopia will become a reality in Copenhagen thanks first of all to the support of the Municipality of Copenhagen and the Danish Government. Equally, our thanks will go to foreign and Danish foundations and individuals that we hope will be inspired to support the ISCC project in Copenhagen like Cité Internationale Universitaire de Paris was financed by patrons like Kansler Konrad Adenauer from Germany, John D. Rockefeller Jr. and Murry Guggenheim from the USA, Wallenberg Stiftelsen from Sweden, Bjarne Eriksen, President Norsk Hydro from Norway, Benny Dessau, President of Tuborg Breweries from Denmark and Émile Deutsch de la Meurthe, President of Shell Oil Company from France.

ISCC will be able to encourage exchanges between high level students of all nationalities by offering them quality housing accommodations. Likewise, accommodation will be provided for host researchers, university teachers and experts on temporary research or teaching contracts in Denmark.

Committed partners

During the summer, ISCC will not only provide accommodation for summer school participants and language school students, but also continue to support higher education and research establishments, institutional organizations, etc. ISCC will strive to play host to organizations wishing to organize summer schools, colloquia, and groups seeking to improve their knowledge of Nordic culture.

With many accommodation places in the future, ISCC will be the leading university campus in Copenhagen, hosting mobile students and academics.

ISCC will provide accommodation for groups or individuals on academic and international, cultural and sporting stays from June to September.

Encouraging Interaction

In order to encourage interaction and socialization, the houses will have a large number of communal areas such as kitchens, music and reading rooms. The mix of nationalities and disciplines, which is part of the statutes of ISCC, will enable the ISCC's ideal to be applied in each house. The law of Brassage will prevent the formation of ghettos.



International students in higher education in Denmark

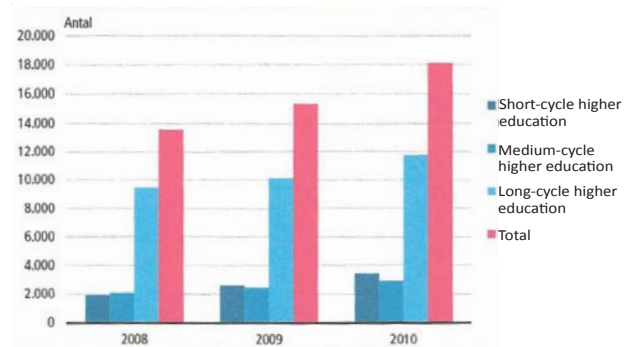

“Denmark has throughout the years received a significant and increasing amount of students coming to the country. The amount of international students in Denmark has increased by a vast percentage of 34% in only two years, 2008-2010, from 13,577 to 18,131, and is expected to hit 25,000 in 2020.”

- Influx of international students to Copenhagen; Maaiké Chaix, CBS; Sophus Bonnén Rossen, H.C Rørdam, Ark. MAA, Copenhagen May 2012



Transport distances

The Metro has a 3 minute frequency service. This cannot be any better! Only one stop to Copenhagen University's southern campus (legal and humanioras), one stop to Danish national Radio Broadcast and concert Halls, 1 stop to the IT University, 4 stops to the heart of Copenhagen, 12 minutes Metro ride to the campuses of Copenhagen Business School. Only 20 minutes to the International Airport, Kastrup and a 5-10 minute bicycle ride to Aalborg University. A Golf course is on the other side of the street, so is the Youth Hostel of Denmark with 400 beds and excellent cafeteria service. Sundby Bad swimming pool, fitness clubs and the multiarena (15.000 audi-ence) are all in bicycle distance from ISCC.

A range of services

Apart from being a housing accommodation provider, ISCC will offer residents comprehensive leisure, catering and learning facilities in order to facilitate their daily lives.

Studying and interacting

ISCC will offer residents: A library open seven days a week, school facilities for language learning, and tailored catering services.

Sporting facilities

ISCC will contribute to the development of university sports via a wide range of facilities either on the grounds or at nearby facilities (stadiums, swimming pool and gyms) and a program of supervised activities.

Facilitating integration

ISCC will also run activities such as cultural programs and language classes, in order to encourage students to integrate. The researchers will have their own club where they can read, chat and organize meetings.

Supporting residents who are having difficulties

It is part of ISCC's plan to provide professional staff for psychological and academic support as well as social assistance, free of charge for those who need it.

At a crossroads of arts and cultures

Hundreds of cultural, intellectual and social events will be held every year at ISCC. They will be organized by the various houses and also by The International Culture House.

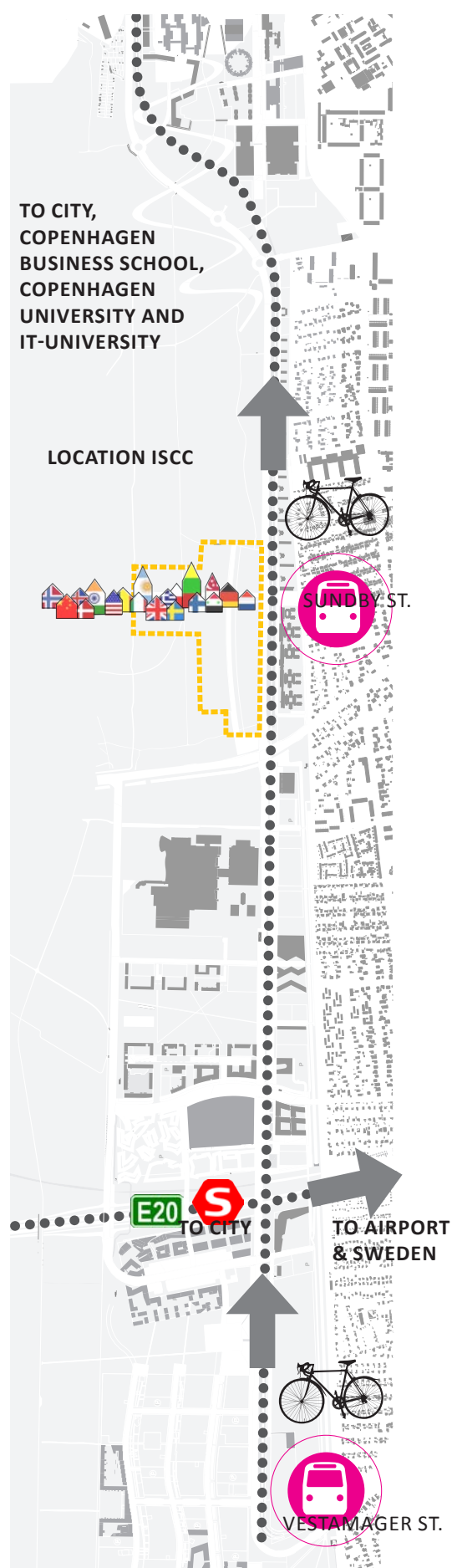

A cosmopolitan program

ISCC's cultural program will be run by the Theatre in the International Culture House. The cultural program will include a wide range of disciplines such as live shows, music and visual arts. Amateurs will be encouraged to contribute.

In the houses

Events linked to the culture of the individual countries or the unique features of a house will be held on a weekly basis and include lectures, concerts and exhibitions. The program will attract international students, researchers and curious members of the Copenhagen public.

Promoting intellectual exchanges

ISCC will be a forum for exchanging and disseminating knowledge. Scientific, cultural and social issues will be addressed during debates and lectures.

International students in Denmark - top ten countries/regions 2010

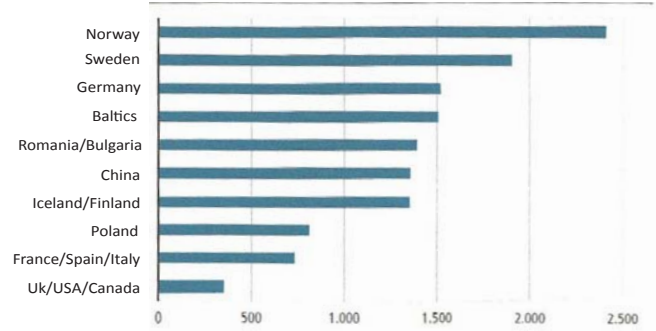

"71% of the international students in Denmark are from the EU, whereas the majorities are from the northern European countries; Norway (2410), Sweden (1902), Germany (1518) and Iceland (1184). Furthermore the amount of Chinese students in Denmark has been undergoing a great increase, and China has become the country that sends the most students to Denmark (outside of Europe), with around 1400 students."

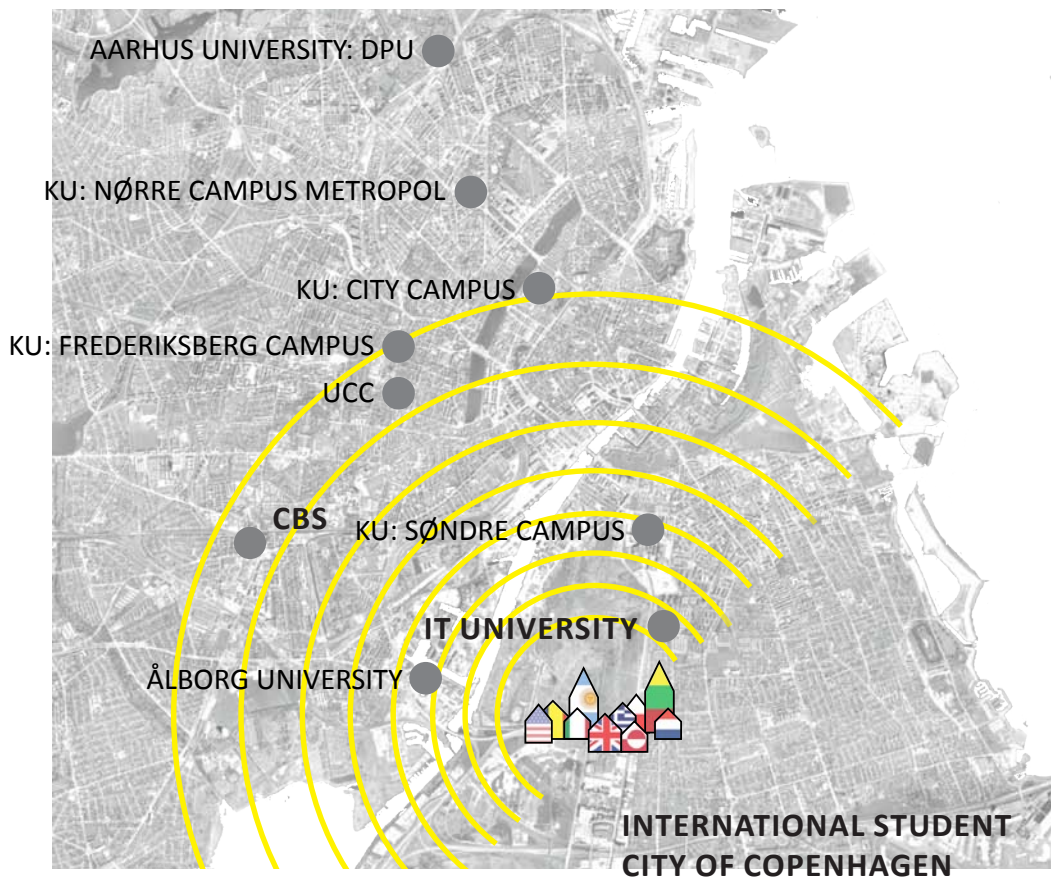

ORGANISATION

The structure of the ISCC project is the foundation “Fonden for ISCC” and its secretariat (ISCC homepage: www.iscc.nu). The foundation, which is a private, non-profit, self-owned organisation, will be registered in Denmark and subject to Danish legislature when the base capital of DKK 1 mill. has been paid up. The foundation will constitute a Board of Directors. The founders of ISCC propose the composition of the Board of Directors to be the following (to be adjusted):

The Chairman of the foundation should be chosen from amongst leading personalities in Danish commerce and industry.

The Vice-Chairman should be chosen from amongst the presidents of the Copenhagen universities, i.e. Copenhagen University, Copenhagen Business School CBS, Denmark Technical University, IT University of Copenhagen and Roskilde University RUC. The Vice-Chairmanship should rotate over a 2 year period. The founders of ISCC propose the president of Copenhagen Business School, Professor Per Holten-Andersen, as the first Vice-Chairman.

A representative from The Municipality of Copenhagen should be appointed by the Lord Mayor, Frank Jensen.

A representative from the Ministry of Higher Education, Innovation and Research should be appointed by the Minister Morten Østergaard (possibly from the Academy of Sciences, Videnskabernes Selskab).

Ambassador Anne Dorte Riggelsen, Paris, representative of international aspects of ISCC.

CEO Peter Schütze, representative of finances who also is chairman of CBS (proposed).

Representative of the ISCC Masterplan, architecture competitions and building projects, adj. prof. Louis Becker, HenningLarsenArchitects A/S.

Student representative, Chairman Danske Studerendes Fællesråd DSF, Jakob L. Ruggaard.

Representative from Nordisk Råd, Haldor Asgrimsson, former secretary of foreign affairs the State of Iceland (proposed).

2 representatives from major sponsors.

Representative of the original founders, Jørgen Rossen.

The ISCC Secretariat will be responsible for the following tasks:

Fundraising, appointing fundraisers and contact persons for each country

Strategies and further development of visions

Supervision of the development and building designs through a design review panel

Assisting the coordination of architect competitions

Overview “Circle of Friends”, Manager: Peer Kølendorf (proposed), INSEAD, Entrepreneur in Residence

Budgets, accounting and economy

The ISCC Secretariat will be managed by Jørgen Rossen, assisted by Finn Junge-Jensen, former president CBS and by Commissioner of DJØF Pia Gjellerup, former Minister. The ISCC Secretariat will report to the Board of Directors.

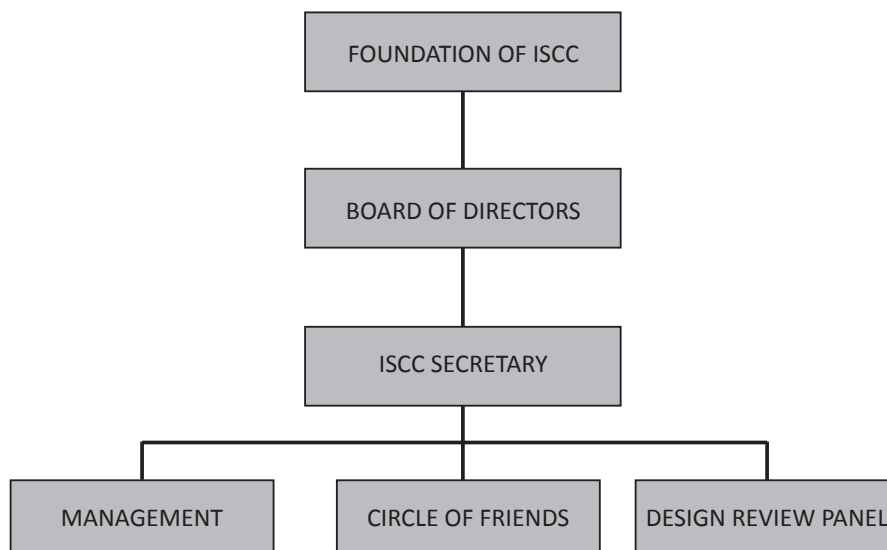

VISION

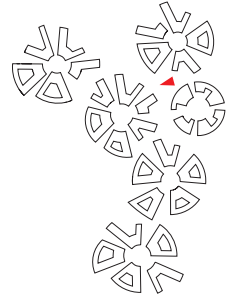

View into Amager Fælled's exterior urban public space (Cluster A)

LOCATION: ØRESTAD



LOCATION: CONTEXT

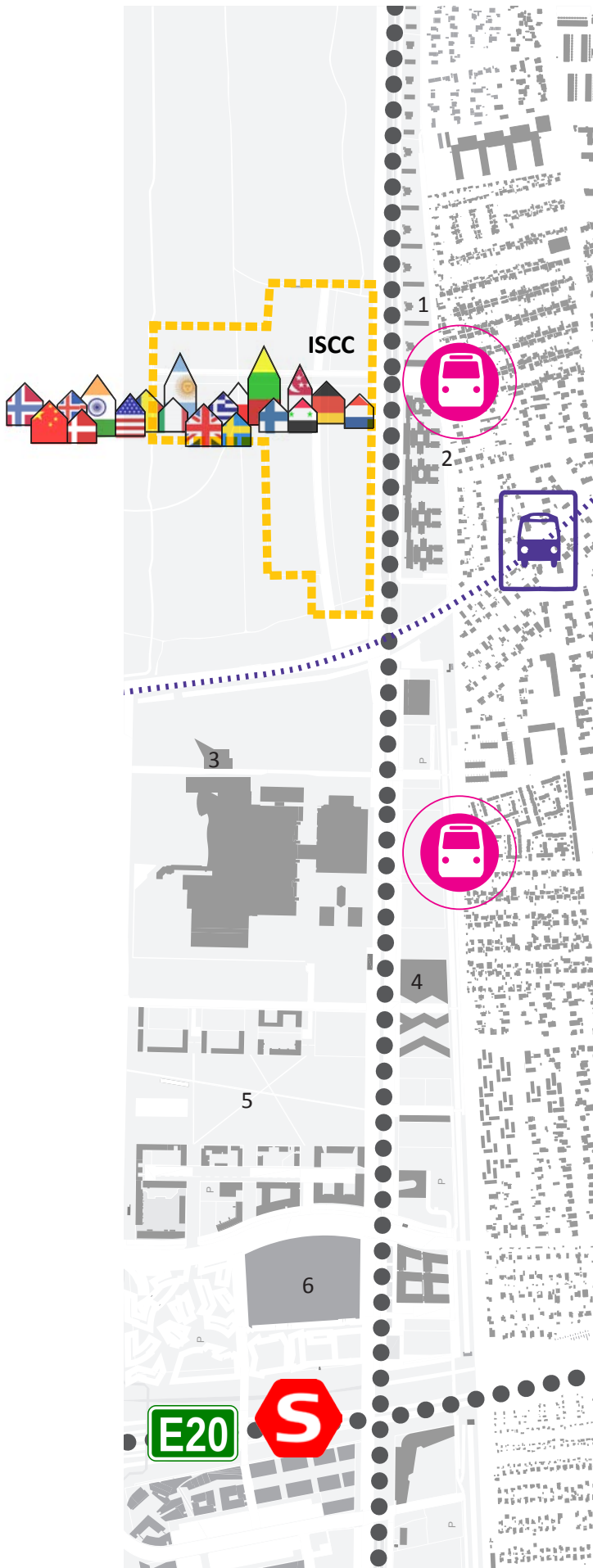

1. Housing Along Ørestads Boulevard



2. Ørestad Metro



3. Bella Sky



4. Ørestad Gymnasium



5. Ørestad Byparken



6. Field's Department Store

CONCEPT DIAGRAMS

Meets and Integrates

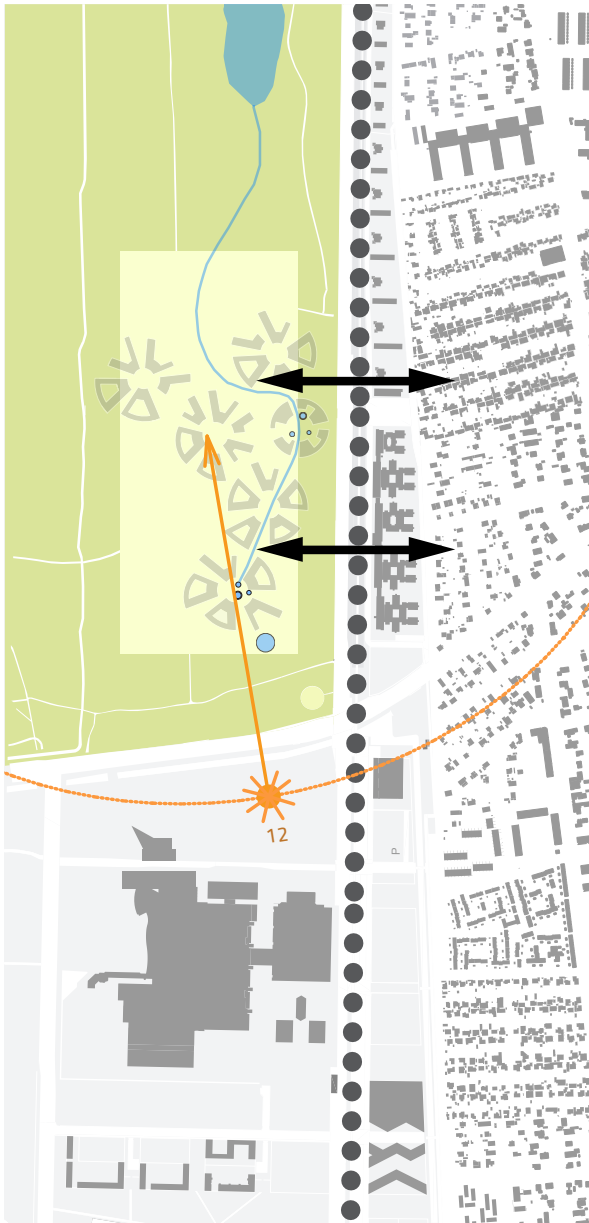

1. Amager Fælled meets and integrates to the city. The sites location and orientation offers a rich potential in terms of daylight and rainwater collection.

Diversified Community



2. The ISCC offering a diversified community that integrates the surroundings and create a unique identity to ISCC.

Views and Comfort



3. The building volumes opens up to the Amager Fælled, yet shielding for the wind and noise from the adjacent traffic.

A Destination



4. The open structure concepts allows free public pedestrian flow through ISCC. As such it becomes a destination and a hub.

CLUSTER THEMES AND STUDENT ACTIVITY

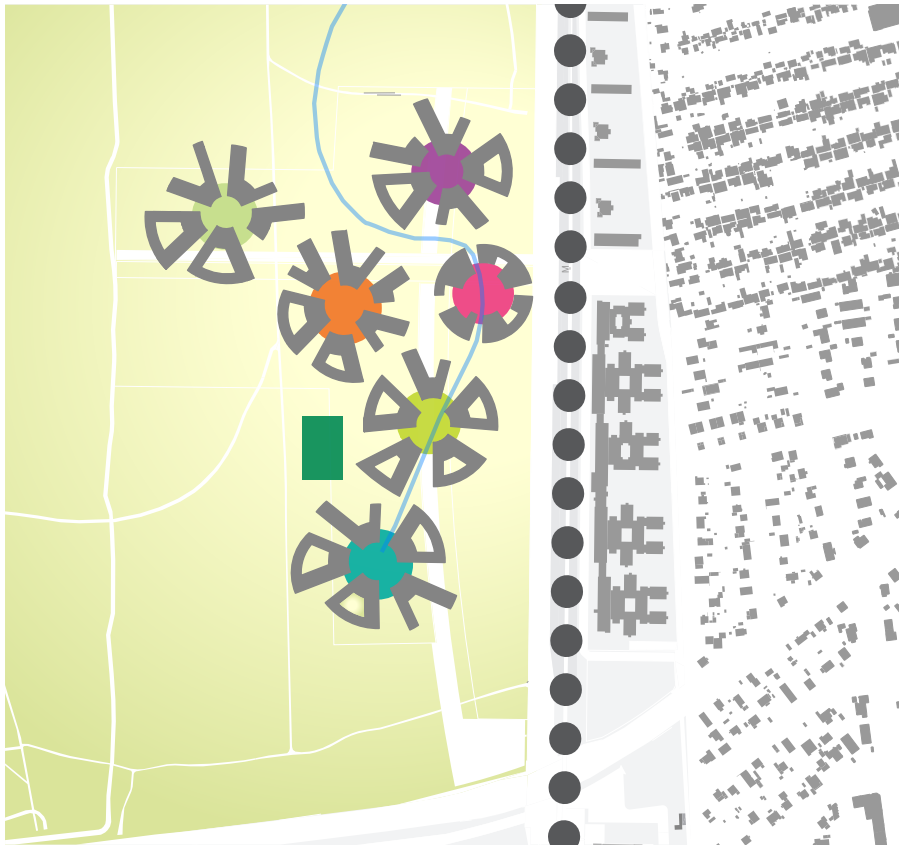

- AMAGER FÆLLED
Cinema, Library, Cafe, Stage, Reading Room
- THE HILLS
- URBAN GARDENS
- SPORTS
- THE FOREST
- RAINWATER COLLECTION
- FOOTBALL FIELD



Gather



Music



Cafe



Socialize



Events



Sports



Study



Dance



Market

SITE PLAN



PERSPECTIVES

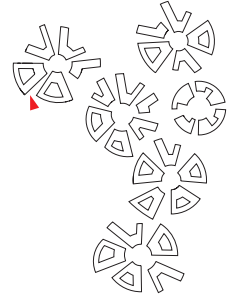

View between Building Clusters through the field, towards Bella Sky

A diversified public realm

The vision for ISCC is to create a diversified vibrant public realm, an urban destination, where each of the clusters offers a distinct identity through different themes and activities. Thereby, each cluster becomes unique - a place for recreation, informal and formal events, sports, or simply meeting friends for coffee.

A public park

The ISCC will have 15 hectares of green parkland adjacent to Sundby Metro Station in Ørestad, Copenhagen on one side and the vast green areas of the protected Amager Fælled on the other side. It will become a favorite spot for joggers, cyclers and sportspeople alike. The flora and the fauna, the biodiversity of the area will be protected.

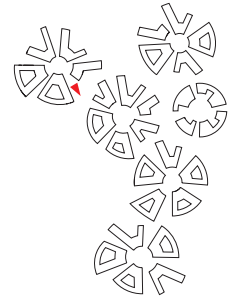

View into the common area of “Urban Gardens” (Cluster F)

Moving towards an eco-campus

ISCC is concerned about global issues and will endeavor to base its day-to-day running and development on a sustainable basis. This commitment will be borne out by the signing of a charter and will be seen in concrete initiatives, such as reducing energy consumption and recycling rainwater and waste materials. Sustainability has been an integrated design parameter when creating the master plan's vision.

BUDGET

An essential part of the vision for ISCC is not only to offer an attractive place to live while studying in Copenhagen, but also to offer attractive and competitive rental rates.

The operation and construction cost is based on the ISCC master plan project of 209.750 M2, of which 5.000 M2 are reserved for the international house (cluster A), which will house shared facilities, a supermarket, cinema, gym, etc.

Operation costs:

Operation income:	
Rent student housing	870 DKK/M2
- providing and average rental cost per unit	3.625 DKK/Month
Operation cost:	
Tax, running cost, maintenance, administration. etc.	510 DKK/M2
Total Estimated Operation Profit: (dedicated for management and cultural activities)	360 DKK/M2

Construction Costs:

Acquisition of land	0 DKK/M2
Cluster A-F including design services	18.000 DKK/M2
Basement	1.000 DKK/M2
Piling	500 DKK/M2
Access roads, soft and hardscape	500 DKK/M2
Project Management	1.200 DKK/M2
All risk insurance	15 DKK/M2
Utility and hook-up fees	1.000 DKK/M2
Permissions	150 DKK/M2
Land surveys	20 DKK/M2
LEED certification or similar	50 DKK/M2
Client consultancy	2.000 DKK/M2
Misc unforeseen	2.000 DKK/M2
Financing of building loan	2.500 DKK/M2
Total Estimated Construction Cost	28.935 DKK/M2

All figures shown are based on gross areas and include taxes. The budget has been developed by Corpus Ejendomme.

COST SCENARIO

The following cost scenario is an example for future nations and their sponsors to provide an overall idea about expected construction costs at the ISCC. Building C2 in cluster C is used for the scenario which could become a student home for e.g. Sweden, Norway, Finland, etc.

Building C2 gross floor area is 6.708 M2 containing 140 student apartments based upon the following:

140 student apartments at an average size of 25 M2	3.500 M2
Lobby, stairs, circulation, lifts, support, technical rooms	2.403 M2
6 Kitchens / dining areas each at 75 M2	480 M2
1 Laundry room	25 M2
1 Common room	100 M2
1 Multi-purpose room (conference, library, music, etc.)	200 M2

Estimated construction cost: 6.708 M2 at DKK 28.935 or total DKK 194 Mill.

Gross rental income: 140 student apartments at DKK 3.625 per month providing total yearly income DKK 6.090.000

Procurement

Inquiries and procurement of building parcels will be done through the ISCC Secretariat. These are yet to be finalised in detail and design manual guidelines, vision and availability of parcels (buildings).

All of ISCC's buildings are to be developed through international design competitions, held by the respective nations and sponsors with support from ISCC. At least 50% of the architects participating in a specific competition must originate from the respective nation. ISCC and its Design Review Panel will participate in the evaluation and selection of all designs.

All nations are expected to present their projects to ISCC and its Design Review Panel at the Concept Stage, Schematic Design, Detail and Final Design. It is each nation's responsibility that the building is in compliance with the ISCC design manual guidelines, Danish building codes and so forth. All authority approvals must be obtained by the nation.

BUILDING CLUSTER DIAGRAMS

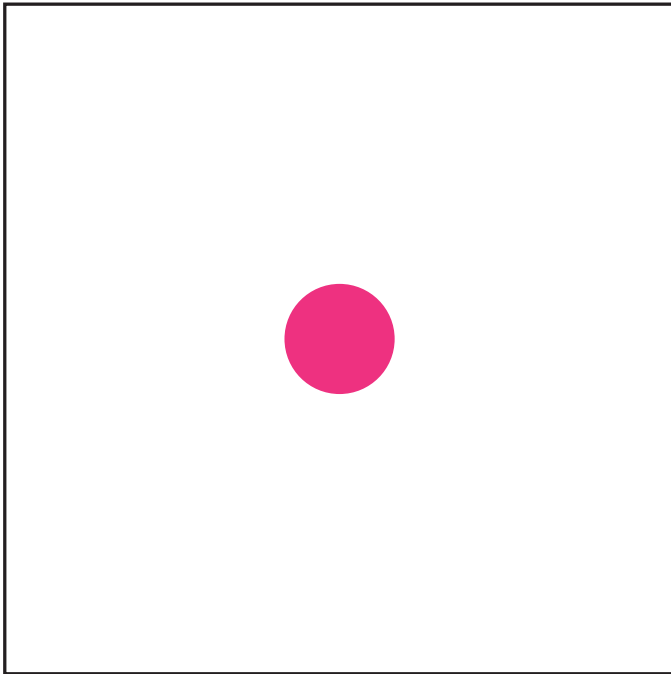

1. Outdoor common room

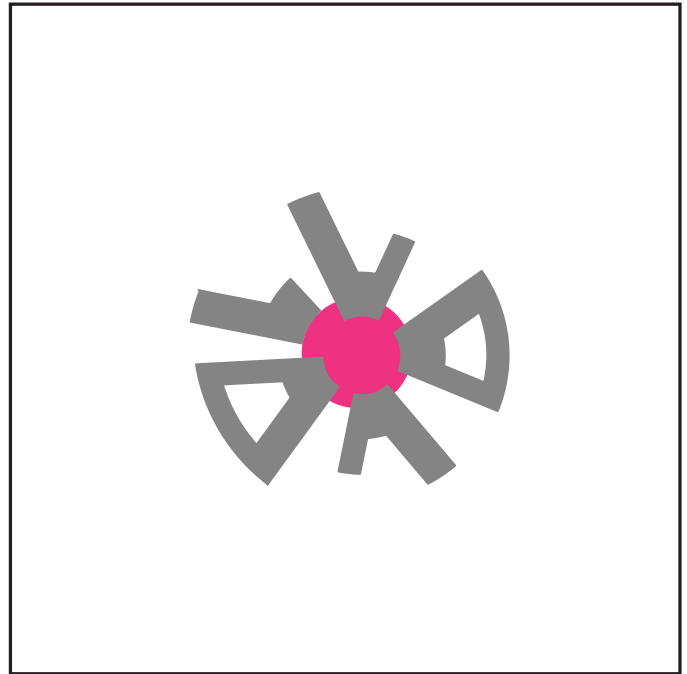

2. Community formed around outdoor common room

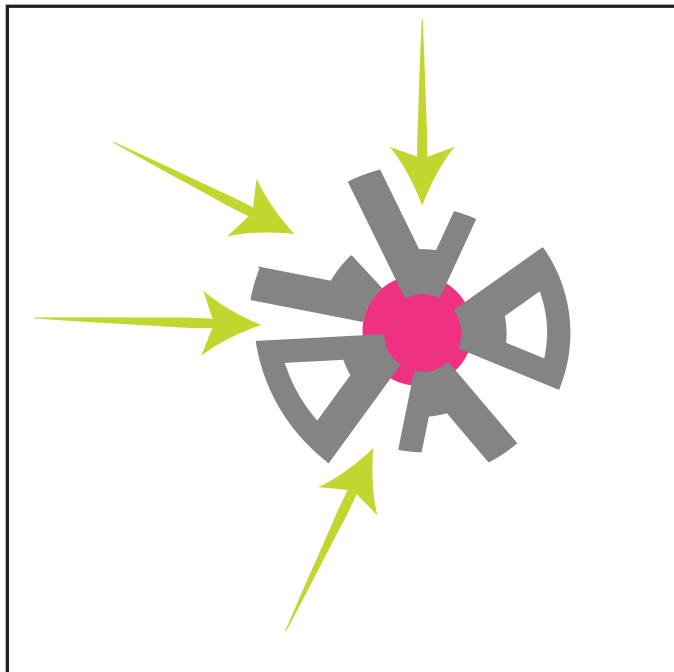

3. Amager Fælled as part of the community

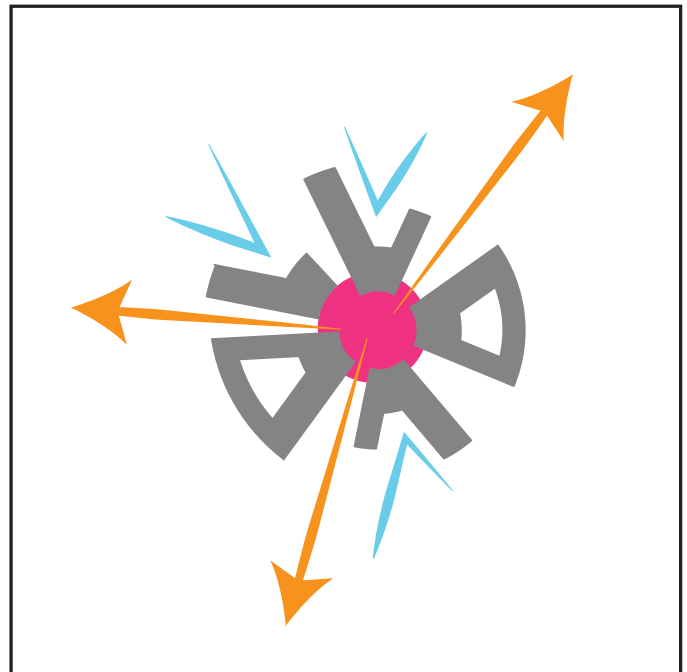

4. The cluster is connected physically and visually

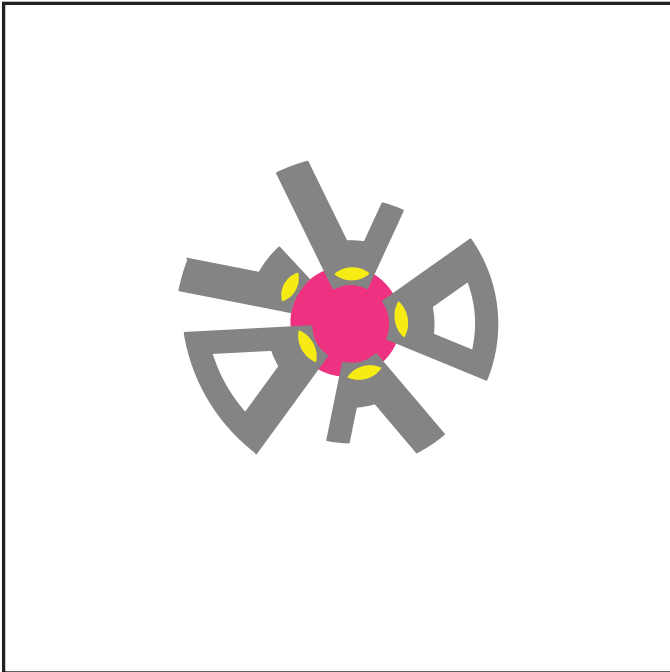

5. Indoor common room is located in the outdoor communal

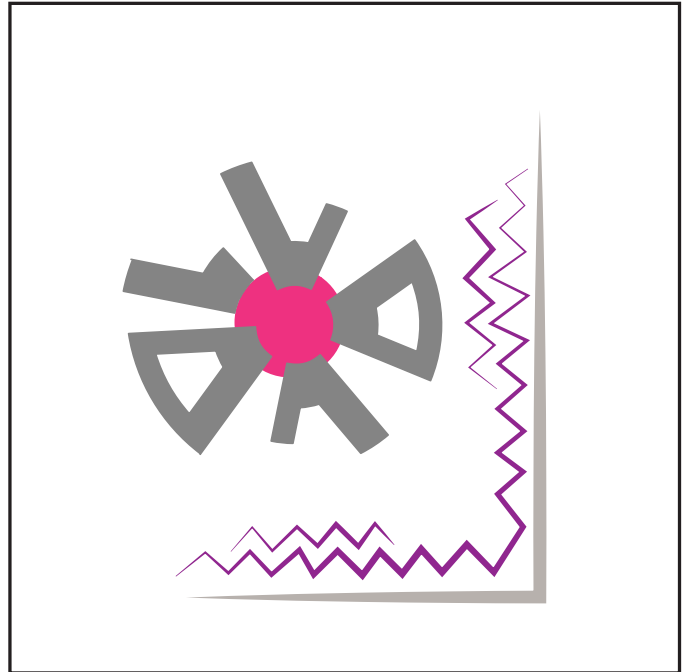

6. The building is closed and shields against noise

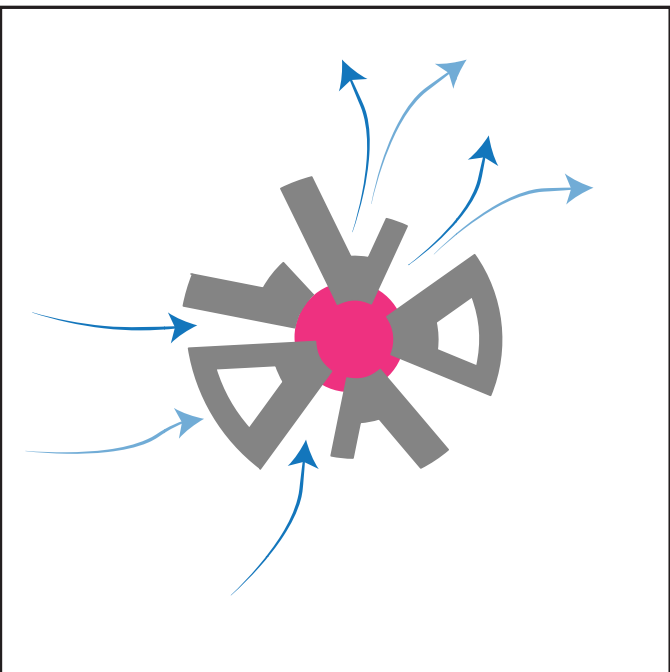

7. The layout provides shelter from the strong winds and comfort in public spaces is optimized

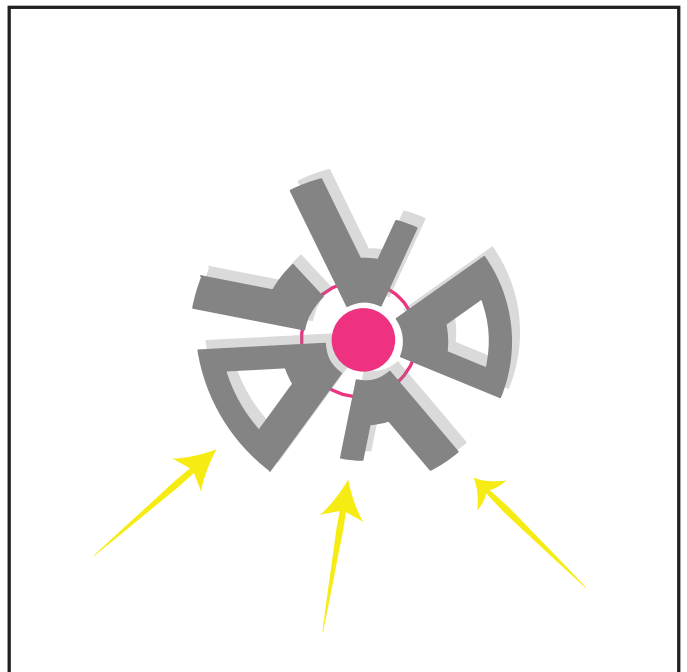

8. The building optimizes daylight

AIRFLOW STUDIES

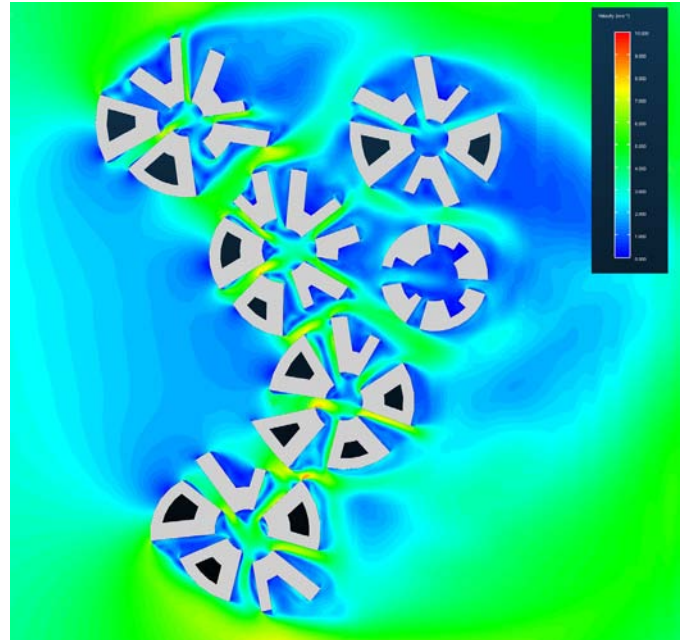
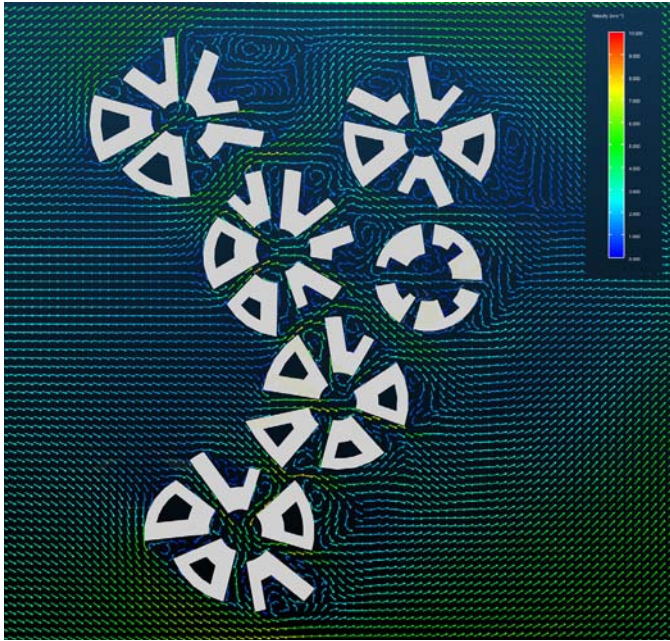

The massing studies of the ISCC is developed through a focus on creating a diversified and vibrant public realm. To ensure optimum outdoor facilities for interaction wind analysis with regard to airflow has been a key design parameter.

CONSTRUCTION PHASES



Phase 1



Phase 2



Phase 3



Phase 4



Phase 5



Phases Complete

BUILDING CLUSTERS

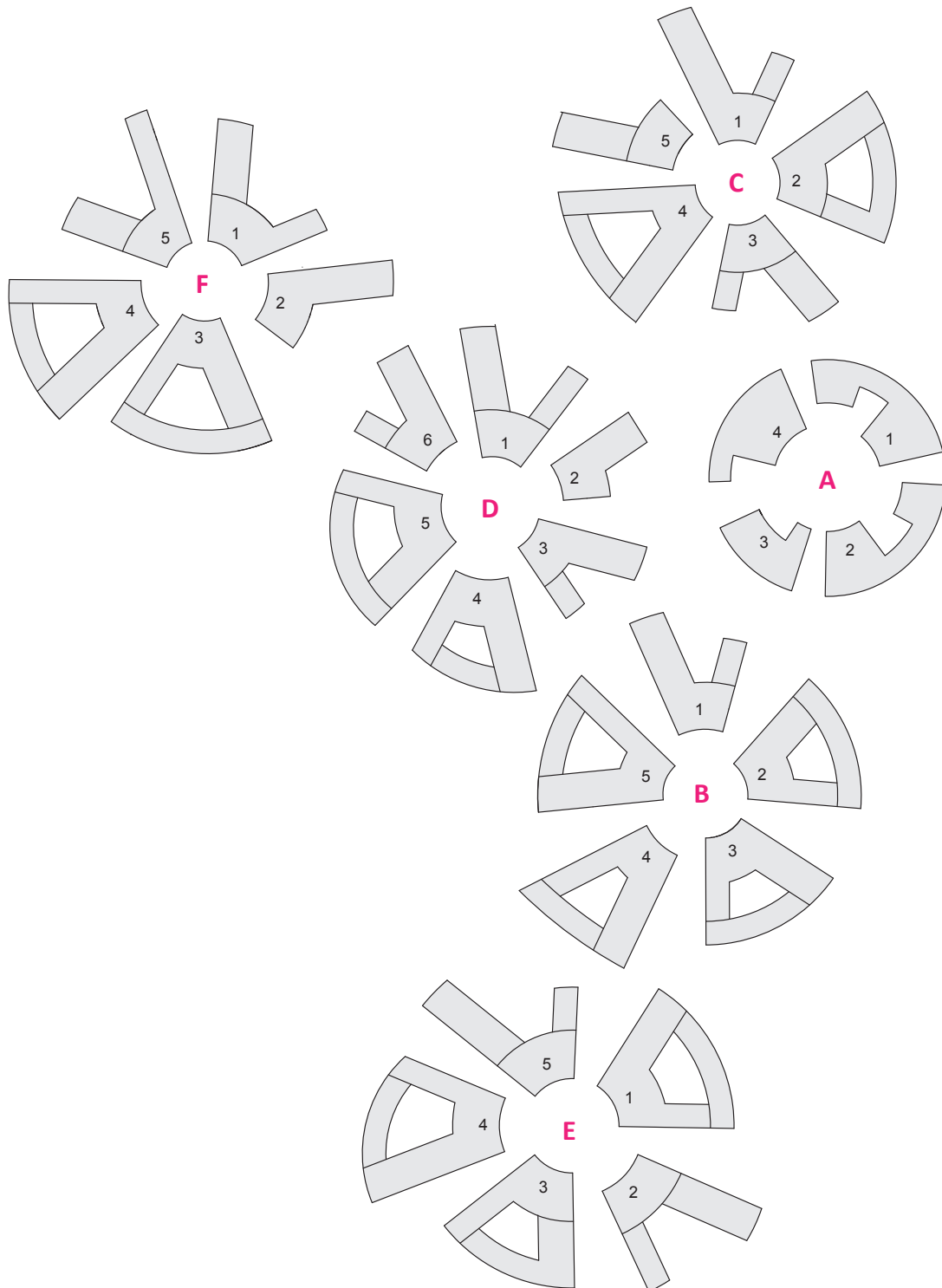

AREA CALCULATIONS

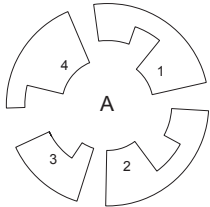

CLUSTER A

A1 (Int'l House): 5860 m²
 A2 (Int'l House): 5850 m²
 A3: 3475 m²
 A4: 5230 m²
A Total: 20,415 m²

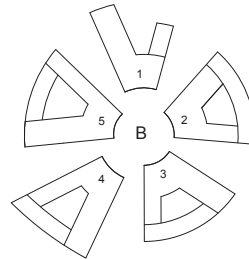

CLUSTER B

B1: 5945 m²
 B2: 9390 m²
 B3: 7720 m²
 B4: 8270 m²
 B5: 8260 m²
B Total: 39,685 m²

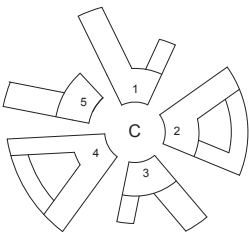

CLUSTER C

C1: 6410 m²
 C2: 6708 m²
 C3: 8385 m²
 C4: 8855 m²
 C5: 4185 m²
C Total: 33,955 m²

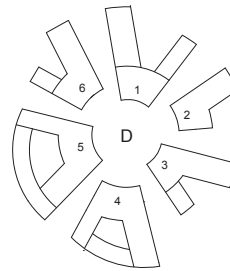

CLUSTER D

D1: 6585 m²
 D2: 3630 m²
 D3: 5155 m²
 D4: 7615 m²
 D5: 8820 m²
D Total: 37,035 m²

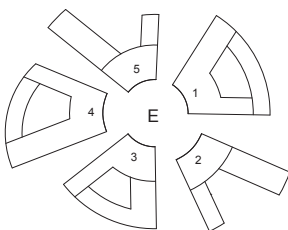

CLUSTER E

E1: 8750 m²
 E2: 7145 m²
 E3: 8125 m²
 E4: 9440 m²
 E5: 6925 m²
E Total: 40,385 m²

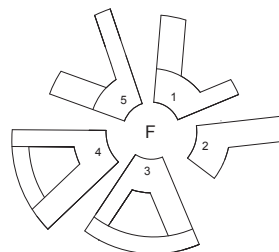

CLUSTER F

F1: 6360 m²
 F2: 5310 m²
 F3: 9275 m²
 F4: 10830 m²
 F5: 6500 m²
F Total: 38,275 m²

KEY DATA:

TOTAL FOOTPRINT: **41,950 m²**

GROSS AREA OF ALL 6 CLUSTERS: **209,750 m²**

Total of 29 Buildings: **27 Student Houses** and **2 International Houses**

BUILDING REGULATIONS

EXAMPLE

C.02

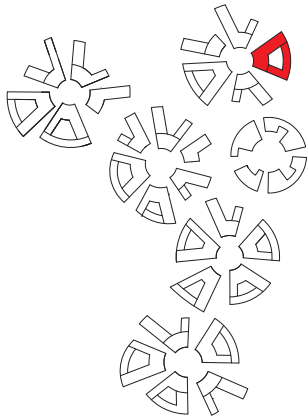

REQUIRED REFERENCES IN PLANNING REGULATIONS

PARCEL GROUND LEVEL (PGL) IN "LANDSCAPE REGULATIONS" CHAPTER

MINIMUM HEIGHT OF BUILT FOOTPRINT IN "HEIGHTS REGULATIONS" CHAPTER

SKYWALK REGULATIONS IN "SKYWALKS" CHAPTER

ROOFSCAPE REGULATIONS IN THE "URBAN REGULATIONS" CHAPTER

SURFACE AND SUBTERRANEAN SECURITY REGULATIONS IN "SECURITY" CHAPTER

PARCEL REGULATION PARAMETERS

- Parcel Area	2,698 m ²
- Gross Floor Area (4 - 6 levels)	5,366 m ² – 8,050 m ² (6708 m ²)
- Tower Height	min 16 m, max 24 m above PGL
- Open Space Easement	between C.01 and C.03
- Public Access Easement	between C.01 and C.03
- Permitted Use	student access

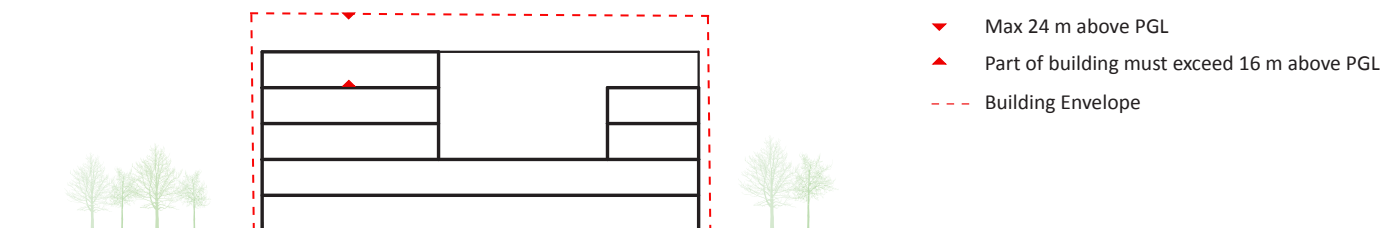





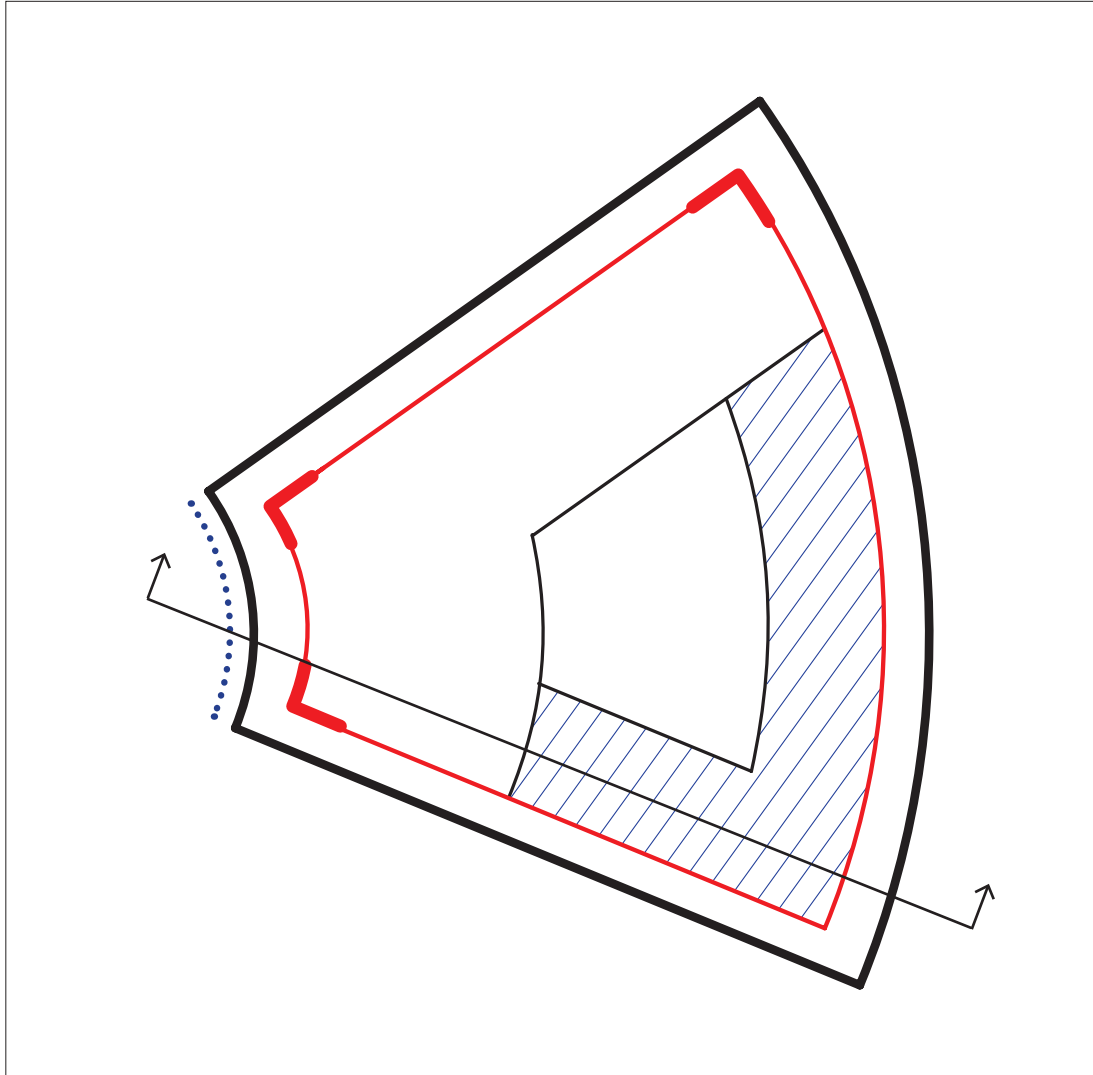

BUILDING REGULATIONS

PARCEL C.02



SIGNS AND SYMBOLS

-  PARCEL BOUNDARY
-  REQUIRED BUILDING LINE
-  BUILDING LINE
-  FACADE REGULATIONS
-  SECTIONAL VIEW
-  HEIGHT RESTRICTION PLANE

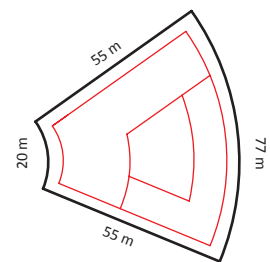

ACKNOWLEDGEMENTS

“Circle of Friends” and financial supporters

Aage V. Jensens Fonde
Aalborg Universitet
Christian Gjersøe
Copenhagen Business School (CBS)
Danske Bank Fonden
DIDA - The Association of Swedish subsidiaries in Denmark
Flemming Eismark
Dr. Anita Mink
Hedorfs Fond
IT-Universitetet
Jørgen Rossen
KIWI, Norges Gruppen ASA
Københavns Universitet
Lise de Neergaard
Morten Riise-Knudsen
NORGES GRUPPEN ASA
Peer Kølendorf
Deloitte, Auditors
Plesner Lawfirm, Jens Zilstorff
Niels Buchholst

ADVISORS to the ISCC Project

Financials: Deloitte, CEO Anders Dons
Legal: Plesner Lawfirm, Amerika Plads 37, Copenhagen, Adv. Jens Zilstorff
Legal: Købmagergade 3 Lawfirm, Copenhagen, Adv. Morten Riise-Knudsen
By & Havn I/S, Dir. Development Michael Soetman and Project Leader Britta Køster
Former President DTU, Professor Hans Peter Jensen
Former President CBS, Professor Finn Junge-Jensen
Commissioner of DJØF Pia Gjellerup, minister for Trade & Industry and for Finance 1998-2001
Mads Øvlisen, adj. Professor CBS, former Chairman of Novo Nordisk and Lego Group
Marius Hansteen, directeur de La Fondation Danoise, Paris
Marianne Bak Papiou, La Fondation Danoise, Paris
Christiane Deussen, dir. Maison d'Allemagne, « Heinrich Heine », CIUP, Paris
Peer Kølendorf, INSEAD, Fontainebleau, Entrepreneur in Residence, France
Author and Journalist, Richard Oestermann
Bente Dalsbæk, Jurist & Kommunikationsrådgiver, Copenhagen
Anne Marie Larsen, CBS Board member, former vice chmd. DSF
Dir. Niels Buchholst, Former resident Fondation Danoise, Paris, former INSEAD alumni. President Euromic A/S
Attorney Lars Berg Dueholm, Member of the City Council of Copenhagen
Project leader Thomas Møller Kristensen, KU, Copenhagen University
Chairman Ole Wiberg, Hedorfs Fond, Denmark
Architect Marianne Vejen Hansen, former Chief campus buildings, KU 2008-11.
Attorney Mette Skov, Aage V. Jensen Fonde, Copenhagen
Culture Journalist Ulla Strømberg, Copenhagen
Architect maa, H.C.Rørdam, Charlottenlund,
Prof. Peter Møllgaard, Head of Department of Economics CBS
Prof. Anders Sørensen, Department of Economics, CBS
Chairman of DSF, Jacob L. Ruggaard

SWEDEN

Dir. Jockum Hultén, Snowball Capital, Malmö, Sweden
Ole Wulff, SEB Merchant Banking, Copenhagen

Prof. Jan Annerstedt, Lund, Sweden
Ambassador Lars Grundberg, Stockholm, Sweden
Åsa Ekwall, directrice Maison des Étudiants Suédois, CIUP, Paris

NORWAY

Merete Lundemo, minister, Kgl. Norsk Ambassade, Copenhagen
Anne-Liv Eriksen, Innovasjon Norway, Kgl. Norsk Ambassade, Copenhagen
Guri Skoklefeld, Ambassade Royal de Norvège, Paris

FINLAND

Sissi Silvan, Head of Finpro Scandinavia, Copenhagen

FRANCE

Carine Camby, Déléguée générale de la Cité Internationale Universitaire de Paris, Fondation Nationale.
Chambre de Commerce Franco-Danoise, Copenhagen
Chairman Anders Torbøl, Secretary general Rolf Meurs-Gerken,
Ulrik Fonsmark, Int. Press Centre, Ministry of Foreign Affairs of Denmark.

CHINA

Mrs. Xukun Ji, Advisor China – Denmark relations.

CONTACT PERSONS FOR INDIVIDUAL COUNTRIES

DENMARK

Jørgen Rossen, 2100 Kbh.Ø, tel: +4533116090/+454010 6090, Mail: rossen@rossen.com
Finn Junge-Jensen, Mail: fjj@cbs.dk
Pia Gjellerup, Mail: pgj@djoef.dk
Jens Zilstorff, Mail: jzi@plesner.com
Or contact founders and “circle of friends”

NORWAY

Christian Gjersøe, Corpus A/S, Copenhagen tel: +4528888922, Mail: cg@corpusejendomme.dk

SWEDEN

Prof. emer. Dr. Sam Nilsson, Helsingborg, Sweden, tel. +46705977161, Mail: sam.nilsson1@gmail.com
Ole Wulff, SEB Merchant Banking, Copenhagen, tel: +4533281060/+4561554262, Mail: ole.wulff@seb.dk

GERMANY

Dir. Niels Buchholst, CEO Euomic A/S, Copenhagen, tel: +455636 3402/+4521777035, Mail: nb@euomic.dk

FRANCE

Ambassador Anne Dorte Riggelsen, Ambassade Royale de Danemark, Paris, tel: +33144332121, Mail: annrig@um.dk
Ulrik Fonsmark, Ministry of Foreign Affairs of Denmark, Copenhagen. Tel: +4520706972, Mail: ulrik.fonsmark@umipc.dk

USA

Adv. Morten Riise-Knudsen, Vice Chm. American Club, tel: +453312 2550, Mail: morten@mr-k.dk
Dir. Peer Kølendorf, CEO Comitel Ltd., tel: +457020 2627/+454050 4441, Mail: pk@comitel.dk

CHINA

Mrs. Xukun Ji. E-mail: xiaoukuhn@gmail.com,
Dir. Niels Buchholst, tel: +4556363402/+452177 7035, Mail: nb@euomic.dk

REPUBLIC OF ARMENIA

Ambassador Hrachya Aghajanyan,
Assistant to the Ambassador: Seyran Saroyan, tel: +4535822900, Mail: ss@armembassy.dk

APPENDICES

- APPENDIX 1** Letter from Aalborg University
- APPENDIX 2** Letter from Copenhagen Business School
- APPENDIX 3** Letter from Københavns Universitet
- APPENDIX 4** Student Housing, Case Studies
- APPENDIX 5** International Student City, Case Study
- APPENDIX 6** Design Manual Guidelines Principles

APPENDIX 1: LETTER FROM AABORG UNIVERSITY



Aalborg University Copenhagen AAU-Cph
A.C. Meyers Vænge 15
DK-2540 Copenhagen SV

Telephone: +45 9940 2500
www.aau-cph.dk

Address:
The International Student City of Copenhagen
Copenhagen

Date: 11. September 2012

Reference: LLa/src

Letter of support for The International Student City of Copenhagen

As a small country with an open economy and few natural resources on which to build a sustainable and prosperous society, Denmark is dependent on having a well-educated and dynamic population with strong international ties. A crucial part of building such a population is to ensure that Danish students build strong personal ties with fellow students from other countries, either by working or studying abroad or by meeting students from other countries during their time at leading Danish universities.

The International Student City of Copenhagen is an exciting and visionary project that will help positioning Copenhagen as a leading European centre of education and offer much needed accommodation to international and Danish students alike. The Cité Internationale Universitaire de Paris is the prime example of how an international student city can foster international awareness, academic exchange and growth for individuals and societies as well as affordable accommodation for students, which is at a premium in major cities. As a university that grows rapidly, not least in terms of international students, Aalborg University Copenhagen strongly feels how desperate the housing situation currently is for students in Copenhagen. The situation gets more critical for each year, and accommodation for another 5,000 students will be most welcome. It is with pleasure that we give our strongest support to the project and pledge to participate in a reference or steering committee if so desired.

The projected location for the International Student City of Copenhagen is ideal, both for Aalborg University Copenhagen specifically, for the other institutions of higher learning and for Copenhagen as a whole. By situating the city close to a Metro station, the most central sites as the airport, the universities and the city centre will be within easy reach. Besides this, the project will contribute to making the area into a vibrant and attractive new quarter. So all in all, the vision for the International Student City of Copenhagen is ambitious, needed and will be of high value to Denmark as a knowledge society and to Copenhagen as a centre of research and higher learning, and Aalborg University Copenhagen is proud to support it.

Yours sincerely

Lene Lange, Professor and Research Director
Aalborg University, Denmark
Campus director, AAU Cph

APPENDIX 2: LETTER FROM COPENHAGEN BUSINESS SCHOOL

To the founders of the foundation ISCC
 "The International Student City of Copenhagen"
 c/o Advokatkontoret
 Købmagergade 3
 1150 København K



**Copenhagen
 Business School**
 HANDELSHØJSKOLEN

President's Office/
 Ledelsessekretariatet

Kilevej 14 A
 2000 Frederiksberg

Tel: +45 · 3815 5800
 Fax: +45 · 3815 2230
 www.cbs.dk

22. oktober 2012

Per Holten-Andersen
 President
 pha.is@cbs.dk

Declaration of support to the ISCC-Project

The ISCC-project, as described in the brochure "*The International Student City of Copenhagen – A Place for Global Relations*" is an initiative that will accommodate a very large need for housing of international students in Copenhagen. Copenhagen is internationally recognized for being a city of knowledge and education. The perception of Copenhagen Business School is that Copenhagen has great but unexploited potential for development into one of the World's most esteemed metropolises of knowledge.

The intended location of "The International Student City of Copenhagen" close by a metro station is crucial. The Sundby Metro Station would connect ISCC to ITU, KU Southern Campus, CBS and DTU. There are no more than 3-4 metro stops to the city center, *Christianshavn* and *Kongens Nytorv*. It is our experience that students seek interplay between quietness to immerse themselves into their studies and the inspiring, vibrancy of city life. Location nearby a metro station will make it possible to combine the best of both worlds.

The suggested size – up to 5,000 student accommodations – is realistic when considering that increasing number of international students seeks Copenhagen as their preferred city of study. The area must be large enough to entail recreational areas, as well as making it possible to expand and ensure development over the next 25-50 years.

We embrace the intention to recreate in Copenhagen the international, cultural atmosphere from "Cité Internationale Universitaire" in Paris. Especially the notion of a sizeable international common house alike the one in Paris is considered a defining factor of the entire project.

Copenhagen Business School will, if requested, bring a representative to the task force. I wish you the best of luck with the project, which – when carried out – will have a considerable impact on the development of Copenhagen as a city of knowledge and education.

Best wishes,

Per Holten-Andersen
 President
 Copenhagen Business School.

APPENDIX 3: LETTER FROM KØBENHAVNS UNIVERSITET

KØBENHAVNS UNIVERSITET

Jørgen Rossen
rossen@rossen.dk



Declaration of support for The International Student City of Copenhagen

The University of Copenhagen welcomes The International Student City of Copenhagen as a new and constructive approach to the improvement of the housing shortages for foreign students in Copenhagen. The idea furthermore supports the branding of Denmark as an internationally oriented, knowledge-based society.

It is interesting to emulate the concept of Cité Universitaire de Paris, which is known as a simple and efficient offer to foreign students. The shortage of inexpensive accommodation remains a growing obstacle to the attraction of suitable foreign students to Copenhagen. There is therefore, among other initiatives to increase the amount of youth residences in Copenhagen, a need for initiatives on a large scale specially focused on international students. Naturally, the concept must be customized to fit Copenhagen, so that The International Student City of Copenhagen may guarantee a high status that ensures a good lifestyle and facilitates meetings between Danish and international students. Choosing an area close to a metro station is in the opinion of the University of Copenhagen, a good and correct initiative, which will provide the students with an excellent connection to the city and the universities.

The business model, in which the countries that send students to Copenhagen also finance the project, is innovative. This is obviously a great opportunity for instilling Copenhagen to receive new investments that at the same time may prove to be an incentive for further international cooperation in the field of education. By virtue of its high level of ambition The International Student City of Copenhagen may directly lead to an increase of Copenhagen's reputation on the international market for education. Therefore, the University of Copenhagen declares its support to The International Stu-

4. OKTOBER 2012

CAMPUS SERVICE

TLF 35322626

MOB 30330817

anders.boe.hauggaard@adm.ku.dk

www.cas.ku.dk

dent City of Copenhagen and will gladly share its experience as a member of an advisory board.

SIDE 2 AF 2

Best regards,

Anders Boe Hauggaard

APPENDIX 4: STUDENT HOUSING, CASE STUDIES

Monash Univeristy Student Housing

BVN Architecture, 2012

Monash, Australia

Rooms: 300

Levels: 5

1

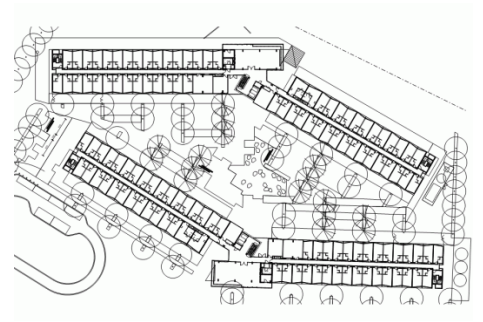

SHN Student Housing Novoli

C+S Architects, 2007

Florence, Italy

Rooms: 250

Levels: 4

2

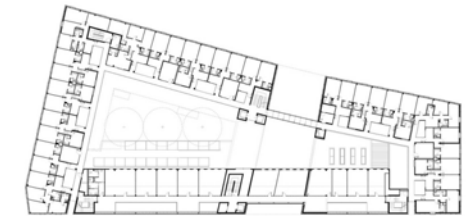

Trondheim Student Housing

MEK Architects, 2012

Trondheim, Norway

Rooms: 116

Levels: 5

3

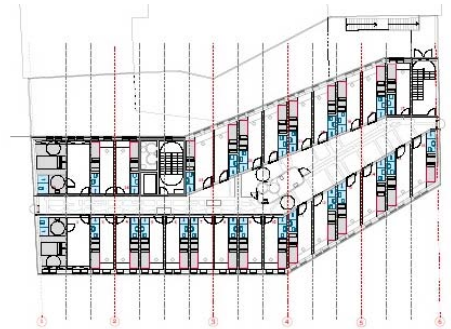

Tietgenkollegiet

Lungaard & Tranberg, 2005

Copenhagen, Denmark

Rooms: 360

Levels: 7

Area: 24,200 sq m

4

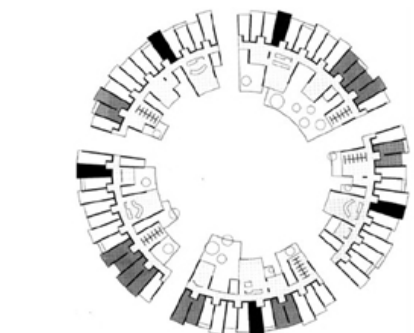

Universitat Politècnica de Catalunya

H Arquitectes + dataAE , 2011
Barcelona, Spain

Rooms: 56
Levels: 2

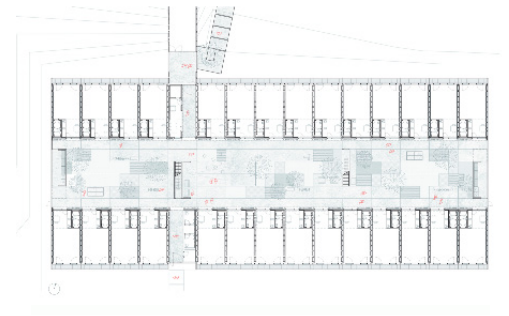

5

The Irene Joliot Curie Residence

Data Architects, 2012
Paris, France

Rooms: 182
Levels: 7



6

Les Lauréades

Lanoire & Courrain, 2010
Paris, France

Rooms: 114
Levels: 3

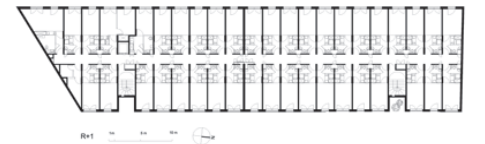
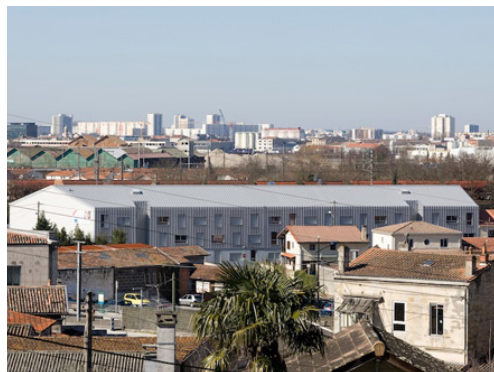

7

CYC Students Residence University

EKKY Studio, 2012
Nicolas, Aglantzia, Cyprus

Rooms: 76
Levels: varies, 3-5
Area: 2,400 sq m

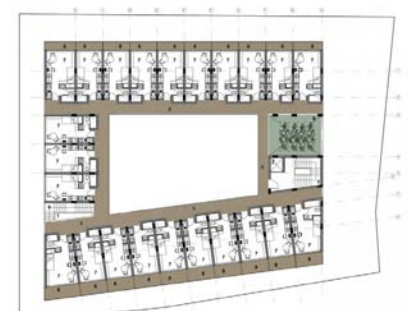

8

APPENDIX 5: INTERNATIONAL STUDENT CITY, CASE STUDY

Cité Internationale Universitaire de Paris / Paris, France

“The residences that make up the Cité Internationale were built **between 1923 and 1969**. The building’s architect based his design on the “**garden city**” concept to create a series of detached houses, providing a model for what would follow. Home to **10,000 students, researchers and artists every year**, over **140 nationalities**, **40 houses** and a host of services, the Cité Internationale offers a unique setting backed by a remarkable organisation. The Cité Internationale Universitaire de Paris is unique among French universities and institutions. It is run by a private body, the Fondation Nationale, and is listed as a public-interest organisation. It manages on-site services and 18 residences. The other 22 houses each represent a country or Grande Ecole and have their own legal status.” (www.ciup.fr/en/)



Site Plan

A



La Mansion Internationale & The Park
Mansion built 1930s / park restored in 2000

B



Tunisia House / built 1947
200 rooms / 7,300 sq m (6 levels)

C



The Franco-British College / built 1937
272 rooms / 8,400 sq m (5+ levels)

D



The USA Foundation / built 1930
267 rooms / 8,000 sq m (6 levels)

APPENDIX 6: DESIGN MANUAL GUIDELINE PRINCIPLES

MATERIALS AND COLORS

DRAFT

4.1 VISION

The vision of KAFD is to create a unified impressive identity. The different buildings of the same type that are located in the same area should refer to and interplay with each other in a harmonious way. The materials and colours of the facades shape the impression and the architectural characteristics of the specific building.

By using materials in high quality and light colours, there will be a harmony between the buildings in KAFD. However, a broad variation in the design is allowed in order to challenge the urban creativity.

The facades also serve the crucial function of providing shelter from weather and climate. The facade design is a major factor in determining the amount of energy a building will use for its operation. Apart from the considerations about materials in the present section the DMG focuses on transparency and shading of the facades, which also has a considerable influence on how energy consumption is reduced.

The character of the material also shapes the impression as the performance of the facade. When designing for a hot climate such as the Saudi Arabian climate the choice of materials that reduce the heat absorption is very important. Materials such as glass or metals can be highly reflective and reduce penetration of radiation inside the buildings. However, it should be kept in mind that the high level of reflected light could become a nuisance to nearby buildings and to people in adjacent open areas. The reflected radiation could also cause a rise in temperature in certain areas such as walls of nearby buildings or paved areas. The façade surfaces may in some cases be used for obtaining solar power through solar cells. Solar cells can be integrated in the facades in various ways. The DMG presents several references as to how this may be done.

By considering the choice of materials and the quality of the materials for the facade construction sustainable demands can be fulfilled.

The DMG presents a range of different materials to inspire the design process of the buildings. The overall environmental life cycle and energy costs associated with the production and transportation of different facade materials are important to consider when building.

4.2 GUIDELINES

Colour

- In regions with significant cooling loads select exterior finish materials with light colours.
- The brightness of the colours should minimum be 70% according to the Natural Colour System (NCS).

Character

- Consider the reflectivity of the facade. Because of the high density of the KAFD masterplan highly reflective facades, such as mirror glass facades, should be avoided to reduce glare from one building to another.

Sustainability.

- Choose local materials that reduce energy consumption for transportation. Choose quality materials that have a long lifetime and a minimum of maintenance.

MATERIALS AND COLORS

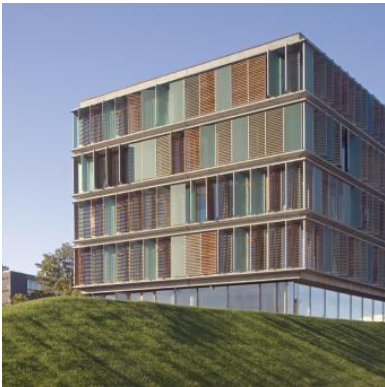

WOOD



BRICKS

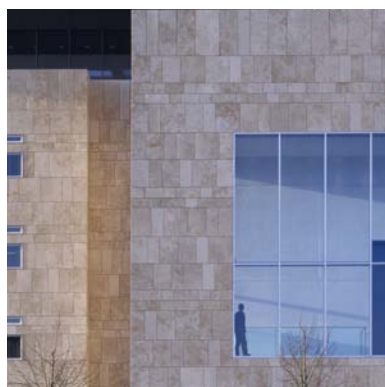
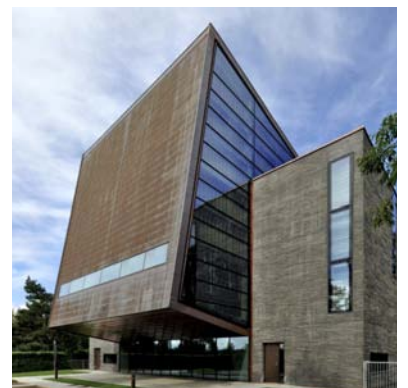

STONE



COLOR

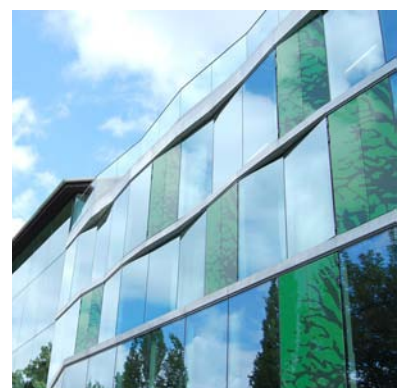

DAYLIGHT AND TRANSPARENCY

DRAFT

Thermal insulation, building envelope

The parameter variation for thermal insulation regarding the building envelope is simulated without insulation and with an insulation thickness of 50 mm and 100 mm. In the thermal simulation the selected insulation material is expanded polystyrene with a thermal conductivity at 0.038 W/m²K. The effect of insulation thickness on energy consumption is illustrated in the figure below

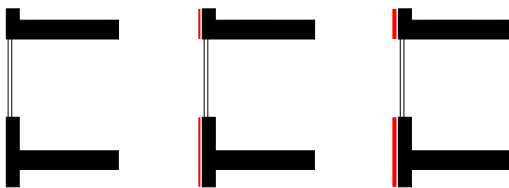
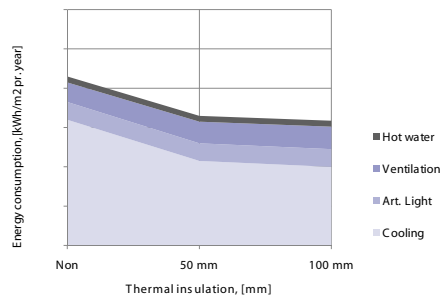

Fig. 04.02 | Thermal insulation | Building envelope



Note: Basis of calculation see Terms and Conditions section 16.0.

Fig. 04.03 | Thermal insulation | Building envelope

Conclusion

With a thermal insulation of 50 mm it is possible to minimise the cooling requirement and the total energy consumption with 30%. As a result, an insulation thickness of minimum 50 mm is recommended as an optimum thickness irrespective of the insulation type.

Thermal insulation, window

The parameter variation for thermal insulation regarding windows describes the effect of different window types. The model is simulated with three different thermal transmissions coefficient:

1. Single glazing 5.8 W/m²K
2. Double glazing 1.8 W/m²K
3. Triple glazing 1.0 W/m²K

The effect of thermal transmission coefficient on energy consumption is illustrated in figure below.

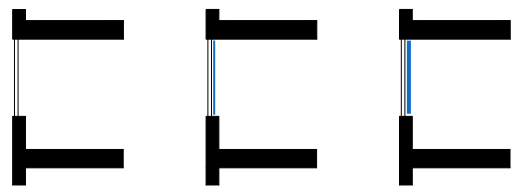
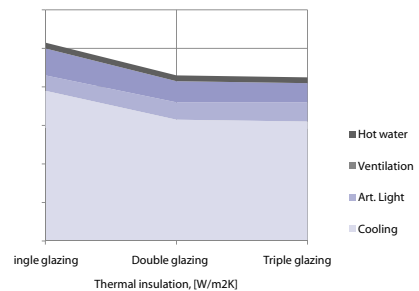

Fig. 04.04 | Thermal insulation | Windows



Note: Basis of calculation see Terms and Conditions section 16.0.

Fig. 04.05 | Thermal insulation | Windows

Conclusion

By choosing double glazing compared to single glazing it is possible to minimise the cooling requirement and the total energy consumption with 20%. As a result, a window type with a thermal transmission coefficient < 1.8 W/m²K (double glazing) is recommended as an optimum solution.

DAYLIGHT AND TRANSPARENCY

DRAFT

5.4 OPTIONS

Diagrams

The diagrams show transparency examples.

Transparency on lower level varies from Financial Plaza to Ring Road. The percentage of transparency (see-through) can vary in relation to the function of the building but should always be constructed within the given percentage.

All facades above the lower level

Transparency south façade above lower level: min 15% - max 20%

Transparency north façade above lower level: min 20% - max 50%

Lower level

Transparency of Financial Plaza facade on lower level: min 50% - max 90% transparency.

Transparency of Wadi facade on lower level: min 50% - max 90% transparency.

Transparency of Attractor facade on lower level: min 50% - max 90% transparency.

Transparency of Square facade on lower level: min 50% - max 90% transparency.

Transparency of Ring Road south facade on lower level: min 15% - max 20%.

Transparency of Ring Road north facade on lower level: min 20% - max 50%.

Transparency of Access Road facade on lower level: min 40% - max 60% transparency.

Transparency of Street facade on lower level: min 40% - max 60% transparency.

Transparency of Cul de Sac facade on lower level: min 40% - max 60% transparency.

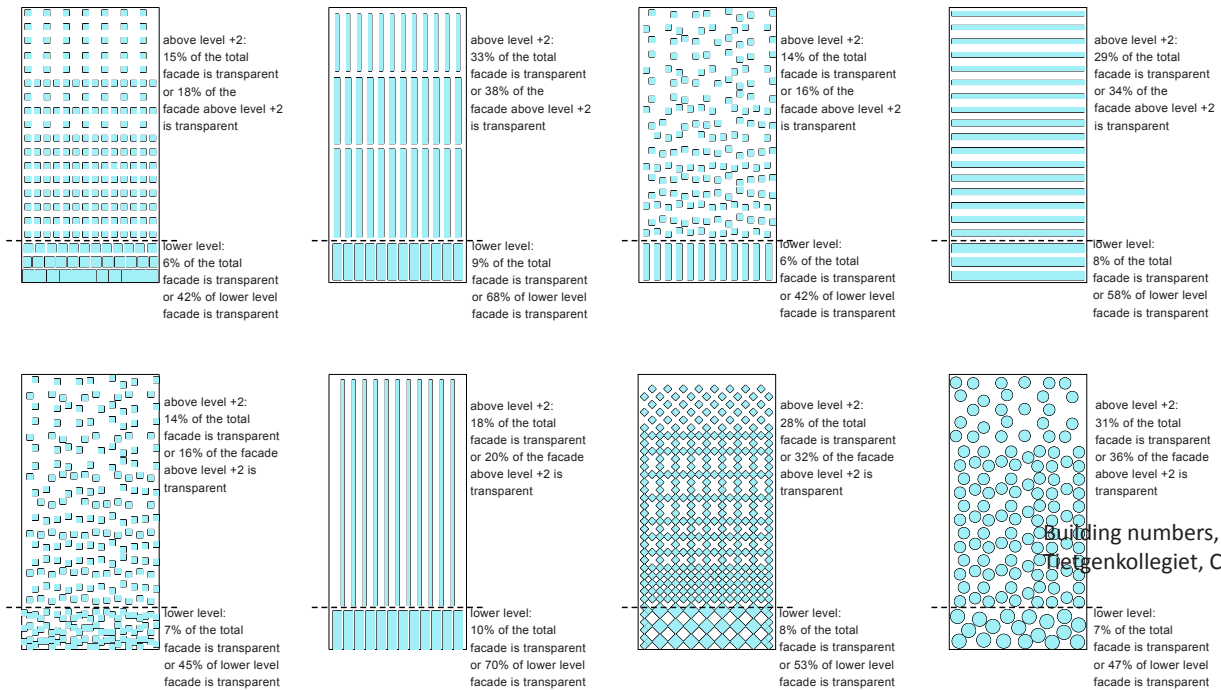

Fig. 05.01 | Examples | Transparency

Building numbers, Dettenkollegiet, Copenhagen

SIGNAGE AND WAY FINDING



Sign as facade and shading
Coffee shop Italy.



Colored signage on glass



Retail signage on streetlevel



Facade sign
Louis Vuitton, Hong Kong



Vannelle Factory | Rotterdam



Interior hallway signage, study room
CBS, Copenhagen, HLA



Student center signage
IIT Campus Center, Chicago



Hanging sign
Agnes b



Interior wall signage, dining hall



Building number, exterior
Tietgenkollegiet, Copenhagen



Room number, interior
DNR, HLA



Numbers, threshold
Westerdals, Oslo

